

## BUTT JOINT

Combining elegance with strength, the Steelfire STB80 Butt Joint system offers a lighter and more refined approach. Designed to minimize intermediate profiles, it maximizes the glazed surface area. This innovative system opens up a multitude of possibilities in design and architecture, creating luminous spaces with enhanced transparency while maintaining impeccable fire safety standards.

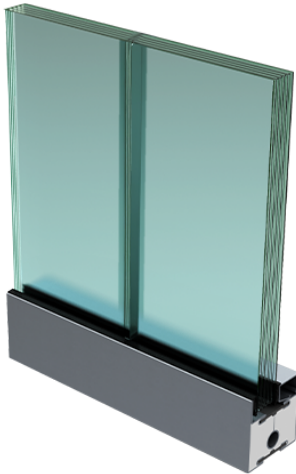

**FIRE RATING: 60/90/120 MIN**



**FIRE RESISTIVE**  
Compartmentalize smoke and flames and block heat transfer

**intertek**  
ASTM E119 & UL 263

**Applus<sup>+</sup>**



### KEY FEATURES:

- Fire rating of 60, 90, & 120 minutes with required hose stream test.
- Glass edge to glass edge connection
- For interior application
- Possibility of creating 90 to 120 degree angles for glass corner joints
- Great acoustic insulation
- With a glass edge-to-edge gap of 4 to 6mm, the space is filled using structural silicone sealant in neutral, gray or black color options
- Maximized glazing area from floor to ceiling
- Available in multiple configurations
- Compatible with any STB80 door system
- Frames can be supplied in either high-performance powder coat finishes or stainless steel with polished or brushed finishes
- Featuring exceptional transparency, the glass ensures a maximum light transmittance ranging from 75% to 82%.

FIRE RATING	MAXIMUM WIDTH	MAXIMUM HEIGHT	FIRE RATED GLASS THK.	MAXIMUM GLASS SIZE	MAXIMUM GLASS AREA
60 mins	Unlimited	3000mm (118-1/8")	27 to 30mm (1-1/16" to 1-3/16")	2890mm W x 2890mm H (113-3/4" W x 113-3/4" H)	4.09m <sup>2</sup> (44ft <sup>2</sup> )
90 mins	Unlimited	3000mm (118-1/8")	37.5 to 40mm (1-1/2" to 1-5/8")	2890mm W x 2890mm H (113-3/4" W x 113-3/4" H)	4.09m <sup>2</sup> (44ft <sup>2</sup> )
120 mins	Unlimited	3000mm (118-1/8")	54mm (2-1/8")	2890mm W x 2890mm H (113-3/4" W x 113-3/4" H)	4.09m <sup>2</sup> (44ft <sup>2</sup> )

Note: Individual Lite sizes cannot exceed the maximum glass sizes shown above. Glasses shown are single glazed. DGU glass thickness varies as it is dependent on the air space and outer pane requirements. Glass pane sizes cannot go beyond the maximum glass area (i.e., glass height can go up to 2890mm (113-3/4" H) but the total glass area cannot be more than 4.09m<sup>2</sup> (44ft<sup>2</sup>))



# TECFIRE

safety is invisible

**STEELFIRE** **STB80**  
STEEL & STAINLESS STEEL SYSTEMS SERIES

## STEELFIRE STB80 60/90/120 MIN BUTT JOINT

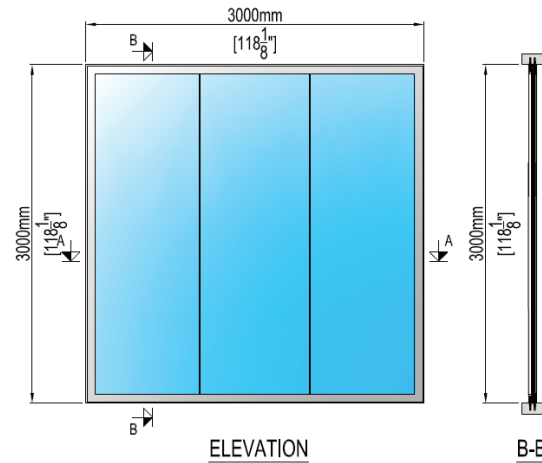
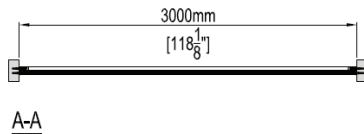
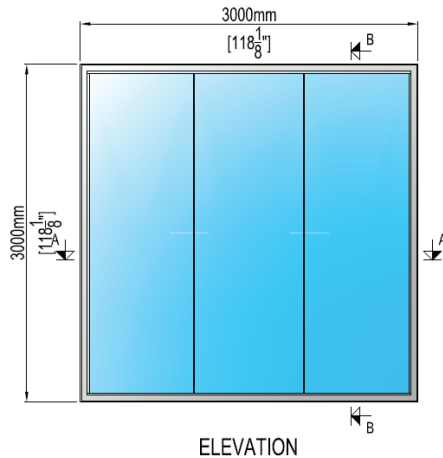

### EXAMPLE OF APPLICATION

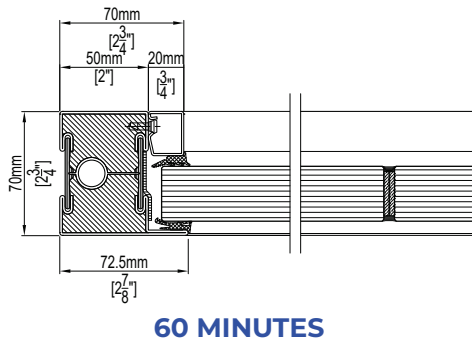

60 MINUTES

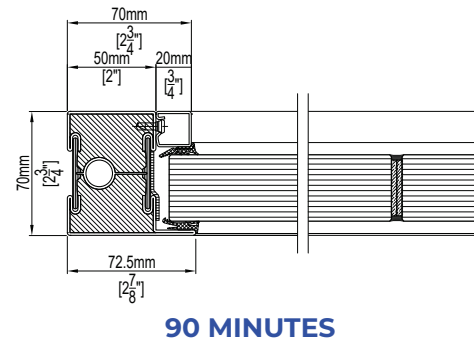

90 MINUTES

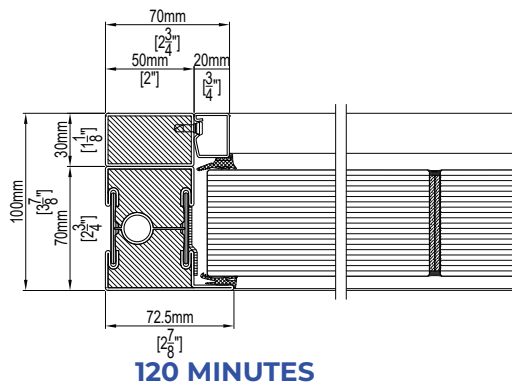

120 MINUTES

[www.tecfire.com](http://www.tecfire.com)



**TECFIRE USA INC.**

**1-833-TECFIRE**



## Intertek ETL US Mark for Partition

Standards: ASTM E119 (2020), UL 263:2011

### CERTIFICATE OF COMPLIANCE

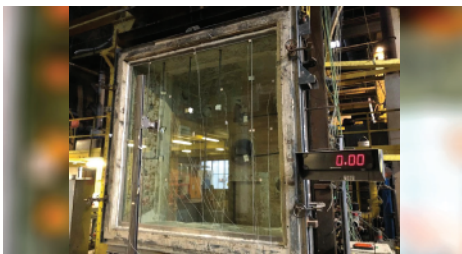

### FIRE RESISTANCE TEST



### HOSE STREAM TEST

**intertek**  
Total Quality Assured

**Certificate of Compliance**

You have been awarded:  
**Intertek ETL US Mark for Partition**  
Version: 4076 (11/01/2020), UL 263:2011 (2011)

Certificate number: 101023-37726701

Organization: Tecfire Middle East SL  
Pol. Industrial Sector 9, Calle Venerito No. 1  
Yanver, Toledo 45529  
Spain

Product: Tecfire - SteelFire STB80 Fixed Partition Assembly -  
ASTM E119/UL 263  
Spec ID: 70221  
Fire Rating: 1 Hour Fire Rating, 1 Hour Fire Rating, 1-1/2 Hour Fire Rating  
(Long information: see following pages)

Certification body: Intertek Testing Services NA, Inc.  
Initial registration: January 17, 2009  
Date of expiry: December 31, 2025  
Issue status: 7

Authorized By:  
Jean Philippe Kayl, Director of Certification  
Intertek Testing Services NA, Inc.  
540 E. Algonquin Road, Suite 200, Arlington Heights, IL 60005 USA  
Phone: 847-439-5867 Fax: 847-439-7329

www.intertek.com

This certificate is issued to certify that the product has been tested and found to comply with the requirements of the standards listed above, and that the product is in compliance with the requirements of the standards listed above. The product is in compliance with the requirements of the standards listed above, and that the product is in compliance with the requirements of the standards listed above.

Tecfire Middle East SL (70221) | Rev: Feb. 7/2025 7/13/2021 | Uncontrolled Copy Page 1 of 2

**SpecDIRECT™** intertek

**LISTING INFORMATION**

SteelFire STB80 fixed partition framing system fabricated by Tecfire Middle East SL is used for glazed fire-resistance rated non-loadbearing fixed partition applications according to ASTM E119 & UL 263 test standards.

The construction details of the glazed fixed partition wall assemblies are given in the design listings noted below.

**FIRE RATINGS**

Test Standards	Rating	Design Listing No.
ASTM E119/UL 263	1 Hour	TFAFGP 80-01
ASTM E119/UL 263	1 1/2 Hour	TFAFGP 80-01
ASTM E119/UL 263	2 Hour	TFAFGP 120-01

Note 1 - The glazing panels used in these assemblies must be listed for fire resistance rating according to ASTM E119/UL 263. The maximum glass dimensions in the finished assembly are the maximum dimensions from the design listings above or the glass manufacturer's size limitations, whichever is smaller.  
Note 2 - Butt-joint glazing details in the design listings are not applicable to T-Frame glazing panels from Tecfire.

Tecfire Middle East SL (70221) | Rev: Feb. 7/2025 7/13/2021 | Uncontrolled Copy Page 2 of 2

### LISTING

Report prepared for public access on 3/1/2023 1:43:52 AM

**intertek**  
Total Quality Assured

**LISTING INFORMATION OF**  
**Tecfire - SteelFire STB80 Fixed Partition Assembly - ASTM**  
**119/UL 263**  
SPEC ID: 70221

Tecfire Middle East SL  
Pol. Industrial Sector 9, Calle Venerito No. 1  
Yanver, Toledo 45529  
Spain

This report is the property of Intertek. Content is not to be reproduced, stored, or transmitted in any form or by any means, electronic, mechanical, photocopying, recording, or by any information storage and retrieval system, without prior written permission from Intertek. The report is not to be used for any other purpose, and its use is limited to the specific project and product for which it was prepared.

Tecfire Middle East SL (70221) | Rev: Feb. 7/2025 7/13/2021 | Uncontrolled Copy Page 1 of 2

**SpecDIRECT™** intertek

**LISTING INFORMATION**

SteelFire STB80 fixed partition framing system fabricated by Tecfire Middle East SL is used for glazed fire-resistance rated non-loadbearing fixed partition applications according to ASTM E119 & UL 263 test standards.

The construction details of the glazed fixed partition wall assemblies are given in the design listings noted below.

**FIRE RATINGS**

Test Standards	Rating	Design Listing No.
ASTM E119/UL 263	1 Hour	TFAFGP 80-01
ASTM E119/UL 263	1 1/2 Hour	TFAFGP 80-01
ASTM E119/UL 263	2 Hour	TFAFGP 120-01

Note 1 - The glazing panels used in these assemblies must be listed for fire resistance rating according to ASTM E119/UL 263. The maximum glass dimensions in the finished assembly are the maximum dimensions from the design listings above or the glass manufacturer's size limitations, whichever is smaller.  
Note 2 - Butt-joint glazing details in the design listings are not applicable to T-Frame glazing panels from Tecfire.

Tecfire Middle East SL (70221) | Rev: Feb. 7/2025 7/13/2021 | Uncontrolled Copy Page 2 of 2